



2022 Early Care and Education Conference “Building the Foundation for Children’s Success Through Intentional Interactions”

**\$10
registration
fee**

Date: Saturday, January 29, 2022

Location: SPC Clearwater Campus

2465 Drew Street Clearwater, FL 33765

Registration Starts: 8:00AM

Conference Starts: 9:00AM

Conference Ends: 1:00PM

**CEU's
Free**

Register here: <https://2022earlychildhoodconference.eventbrite.com>

We are pleased to announce our Keynote Speaker Ron Mohl

Ron brings over 20 years of experience in the education industry to his position of Lead Educational Presenter for Lakeshore Learning Materials. In this role, Ron has presented to school districts, public and private institutions, Head Start programs, and military bases across the country. By focusing on the importance of play in the learning process, Ron's interactive trainings help educators enrich the curricula related to language development, math, science, music and diversity.



Conference Sponsors

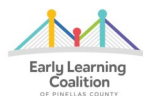

2022 Early Care and Education Conference **“Building the Foundation for Children’s** **Success Through Intentional Interactions”** **Agenda**

8:00am - 9:00pm

Registration check-in and continental networking breakfast
(Ethics and Social Sciences Building)

9:00-9:15

Welcome Announcements

9:15-10:45 -

Session I (Arts Auditorium)

Diving Deeper into Quality of Feedback through Intentional Play

During this session, we will focus on the dimension of Quality of Feedback. We will discuss how to focus our interactions on the process of learning by allowing children to explain what they are doing and why and how to encourage children's responses through follow-up questions, specific feedback and encouragement and affirmation. We will learn how to provide feedback that promotes learning and persistence all while being an intentional partner in play.

10:45- 11:00

Break

11:00-12:30

Session 2 (Arts Auditorium)

Diving Deeper into Concept Development through Intentional Play

As teachers, we must become facilitators who encourage children to expand their learning. Teachers who intentionally plan concepts that are interesting and allow children to experiment and explore their environments not only deepen their learning but also expand their world. We will discuss ways to promote students' higher order thinking skills through intentional play by providing opportunities for children to use analysis, reasoning, and creativity when solving problems. We will also learn ways to connect concepts across activities to bring concepts to life and allow children to apply them to the real-world or their own life.

12:30-12:45

Closing Announcements



Clearwater Campus

Clearwater Campus
2465 Drew St.
Clearwater



KEY

- ACCESS TO DISABLED PARKING
- DISABLED ACCESSIBLE DOORS

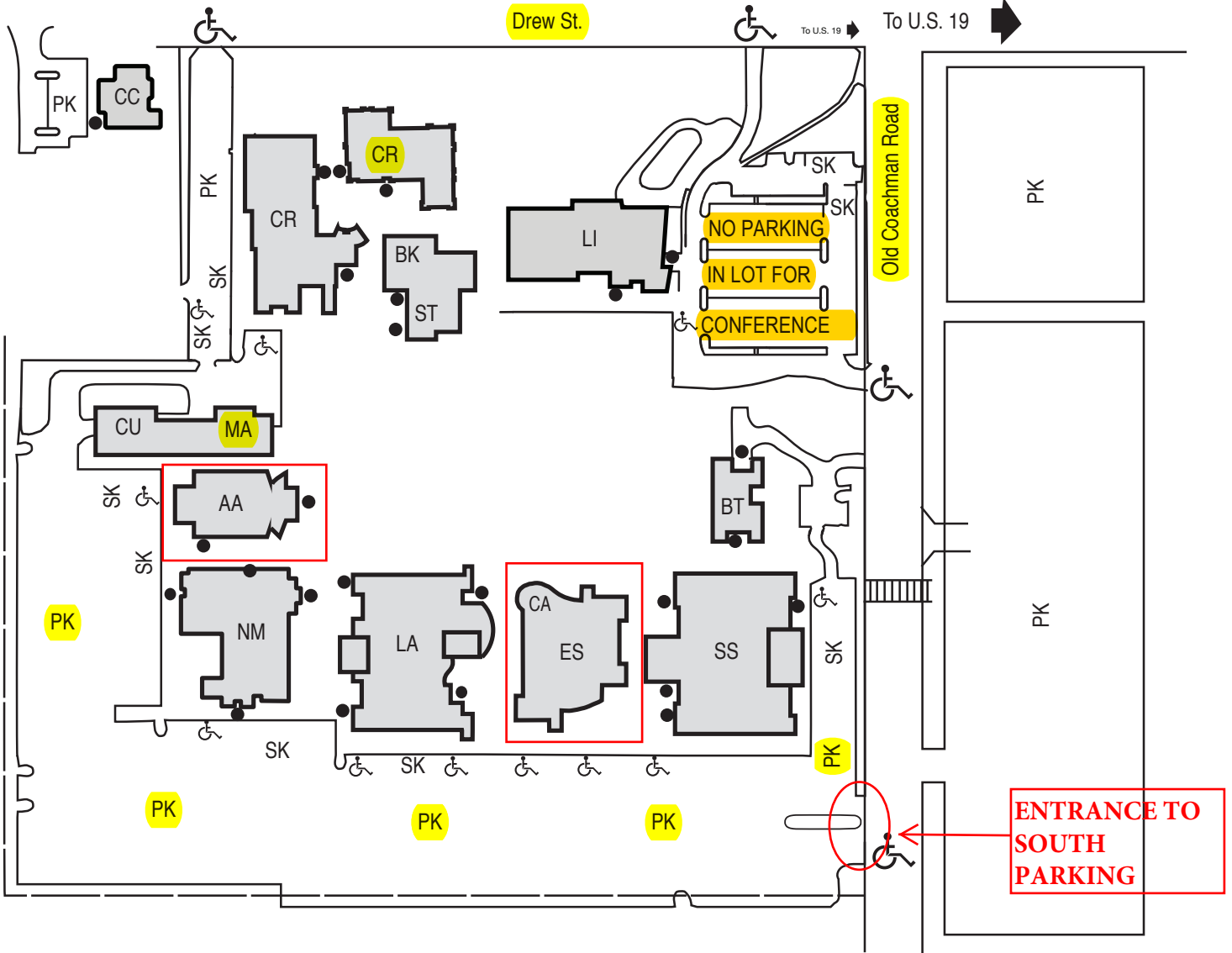

CLEARWATER CAMPUS BUILDING CODES

- | | | |
|---|--|---|
| AA - Arts Auditorium | LA - Language Arts | NM - Natural Science, Math and College of Education |
| BK - Bookstore | • Admissions | PK - Student parking |
| BT - Business Technologies | • Advising | SS - Social Sciences |
| CA - Cafe/Food services | • Business Office | SK - Staff parking |
| CR - Crossroads | • Financial Aid | ST - Student Life and Leadership |
| CC - Collaborative Center for Emerging Technologies | • Testing | |
| CU - Central Utilities | LI - Michael M. Bennett Library and Learning Support Commons | |
| ES - Ethics and Social Sciences | MA - Maintenance | |